

# 1800 Terminal Street Sacramento, CA 95691

Space for Lease  
Light Industrial Space

9,238 SF



9,238 square foot building with 1,800 square feet of office

(2) 12x12 Ground Level Doors - 400 amps power  
3,700 SF Small Fenced Yard - Insulated Warehouse Ceiling

The information in this document was obtained from sources we deem reliable; however, no warranty or representation, expressed or implied, is made as to the accuracy of the information contained herein.



Herb Liverett Companies, Inc.

Herb Liverett  
BRE 01021820  
916-869-8017  
Liverett.herb@gmail.com

2400 Manning Street, Suite B  
Sacramento, CA 95815

# 1800 Terminal Street Sacramento, CA 95691

Space for Lease  
Light Industrial Space

9,238 SF

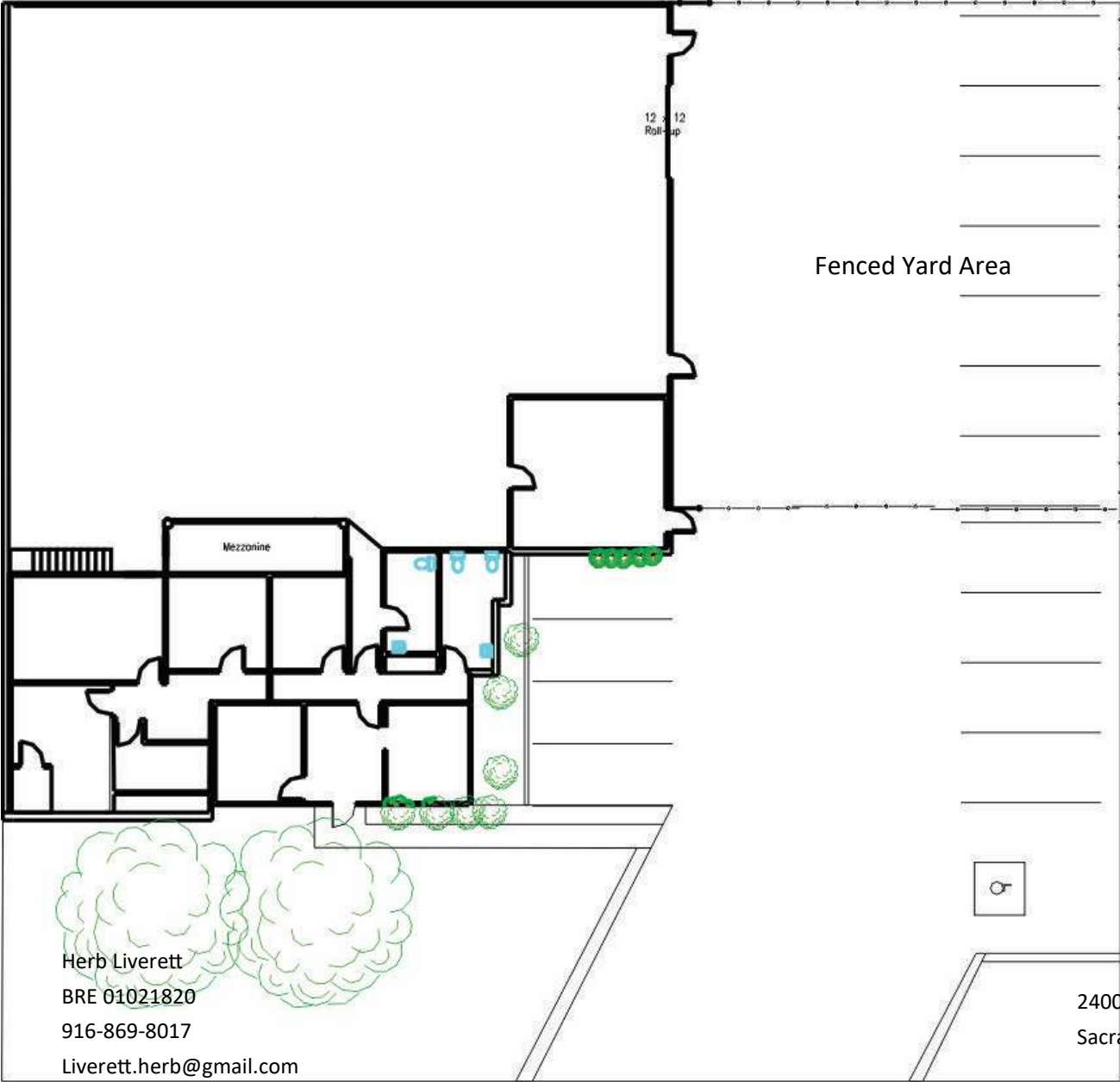

Herb Liverett  
BRE 01021820  
916-869-8017  
Liverett.herb@gmail.com

2400 Manning Street, Suite B  
Sacramento, CA 95815

# 1800 Terminal Street Sacramento, CA 95691

Space for Lease  
Light Industrial Space

9,238 SF

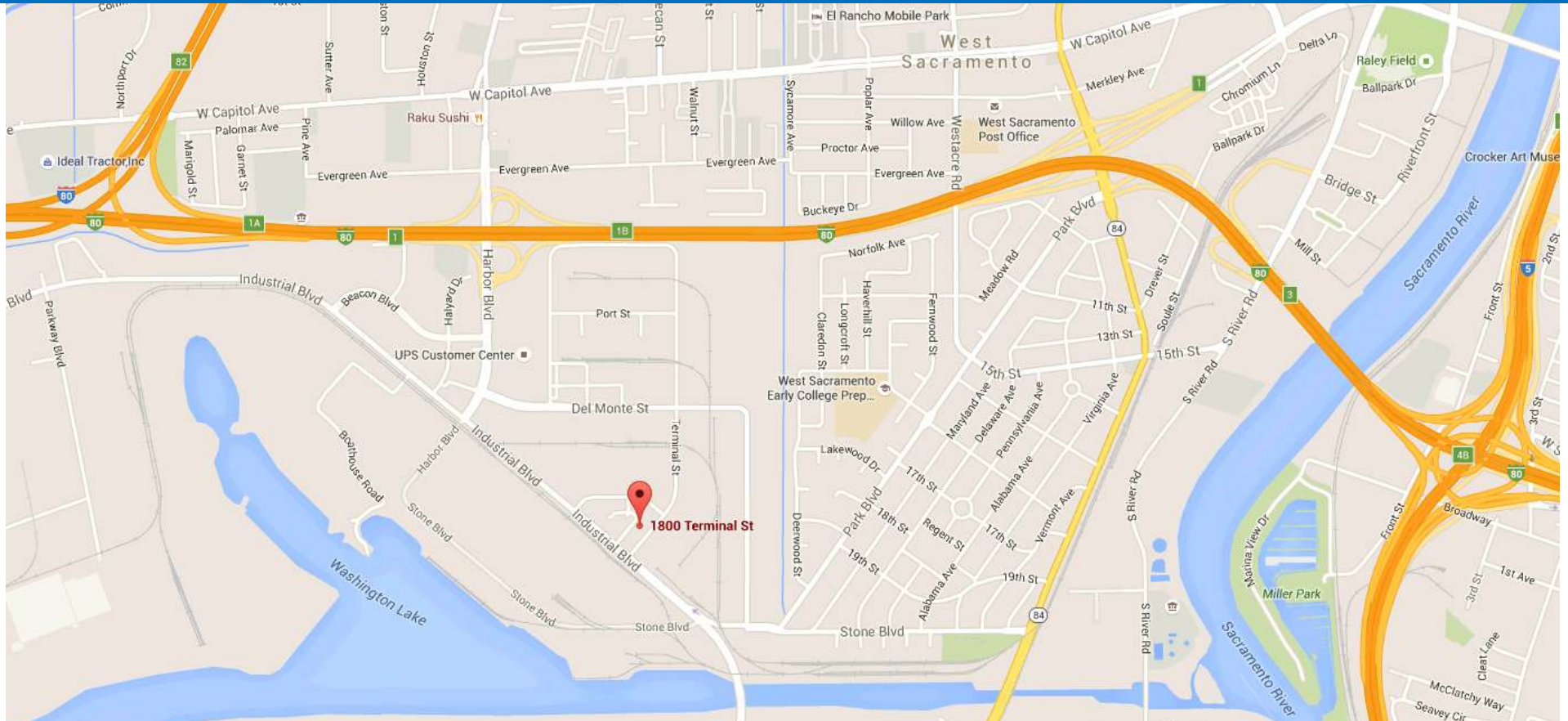

9,238 SF / 1,800 SF Office / (1) 12x12 Ground Level Door(s) / 400 amps  
3,700 SF Small Fenced Yard / Insulated Warehouse Ceiling

The information in this document was obtained from sources we deem reliable; however, no warranty or representation, expressed or implied, is made as to the accuracy of the information contained herein.



Herb Liverett Companies, Inc.

Herb Liverett  
BRE 01021820  
916-869-8017  
Liverett.herb@gmail.com

2400 Manning Street, Suite B  
Sacramento, CA 95815